

INSTALL 1/4"x6"  
LONG PLATES TO  
ATTACH TO BEAM  
AT DESIGN SPACING

THRU BOLT OR  
LAG BOLT  
DEPENDENT  
UPON LOADING

1 1/2"

STEP  
3

**NOTES:**

1. FOR TYPE I HYBRID, GAP MUST BE SIZED TO ACCOMMODATE DRIFT AND DEFLECTION OF BEAM. PROVIDE BACKER ROD AND SEALANT SIMILAR TO C-1.
2. FOR TYPE II AND TYPE III HYBRID, FILL GAP WITH DRY PACK.
3. SIZE THRU BOLTS AND PLATES TO TRANSFER SHEAR.

SCALE: 3/4" = 1'-0"

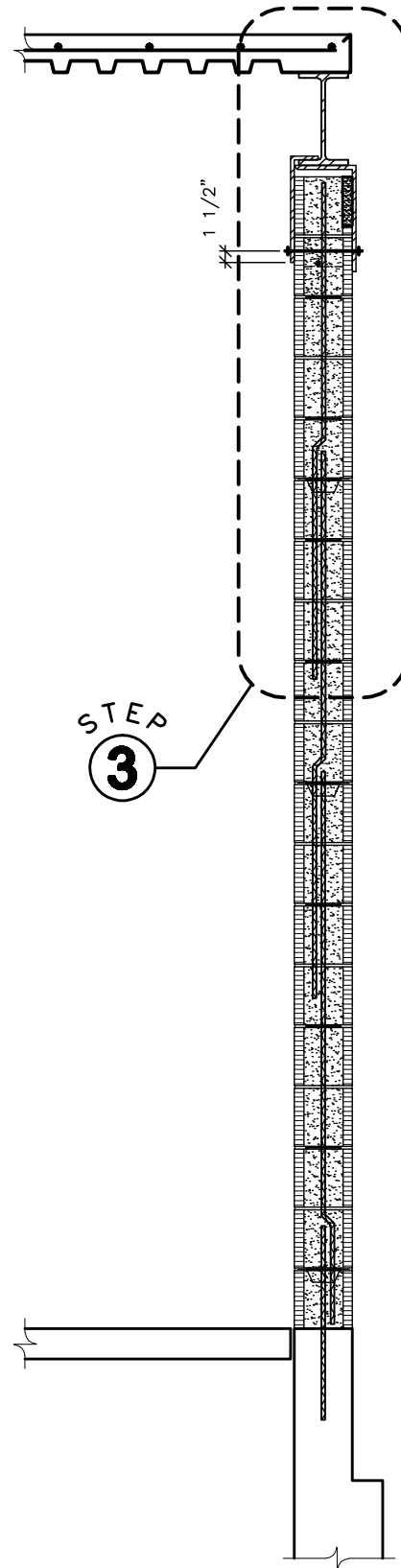

STEP  
3

1 1/2"

SCALE: 1/2" = 1'-0"



**RYAN-BIGGS ASSOCIATES, P.C.**

291 River Street p 518 272.6266  
Troy, NY 12180 f 518 272.4467  
www.ryanbiggs.com

SUBJECT: WALL CONSTRUCTION  
SEQUENCE –  
HIGH LIFT GROUT

PAGE: HL-3

JOB NO.: 9128  
PROJECT: HYBRID MASONRY

DATE: 8/19/08  
BY: DTB